

Floor Plan

GROUND FLOOR
376 sq.ft. (34.9 sq.m.) approx.

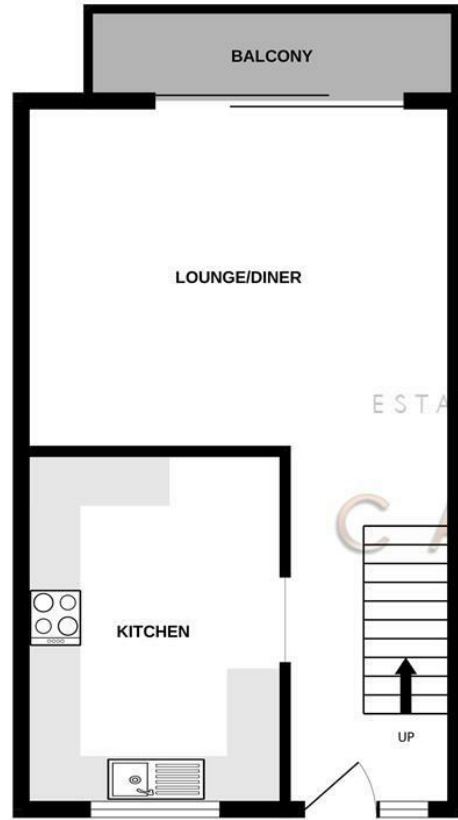

1ST FLOOR
398 sq.ft. (36.9 sq.m.) approx.



TOTAL FLOOR AREA : 774 sq.ft. (71.9 sq.m.) approx.

Whilst every attempt has been made to ensure the accuracy of the floorplan contained here, measurements of doors, windows, rooms and any other items are approximate and no responsibility is taken for any error, omission or mis-statement. This plan is for illustrative purposes only and should be used as such by any prospective purchaser. The services, systems and appliances shown have not been tested and no guarantee as to their operability or efficiency can be given.
Made with Metropix ©2025



These particulars, whilst believed to be accurate are set out as a general outline only for guidance and do not constitute any part of an offer or contract. Intending purchasers should not rely on them as statements of representation of fact, but must satisfy themselves by inspection or otherwise as to their accuracy. No person in this firm's employment has the authority to make or give any representation or warranty in respect of the property.

Energy Efficiency Rating		Environmental Impact (CO ₂) Rating	
Current	Potential	Current	Potential
Very energy efficient - lower running costs (92-100) A		Very environmentally friendly - lower CO ₂ emissions (20-24) A	
(85-91) B		(25-29) B	
(79-84) C		(30-34) C	
(73-78) D		(35-39) D	
(67-72) E		(40-44) E	
(62-66) F	64	(45-49) F	
(55-61) G	66	(50-54) G	
Not energy efficient - higher running costs		Not environmentally friendly - higher CO ₂ emissions	
England & Wales	EU Directive 2002/91/EC	England & Wales	EU Directive 2002/91/EC

Flat 12 Flanders House Bishopsfield Road Fareham, PO14 1RB

We are pleased to welcome to the market this top floor two bedroom duplex apartment in located in Flanders House, Bishopsfield Road, Fareham.

The property is well presented and the ground floor of the home features lounge diner with sliding door to balcony at the rear with a generous kitchen to the front.

Moving up to the second level there are two double bedrooms and a modern family shower room.

The property does come with a lock up for storage and has a residents car park which is on a first come first serve basis.

For more information or to arrange a viewing please call Castles today.

Asking price £175,000

Flat 12 Flanders House Bishopsfield Road

Fareham, PO14 1RB

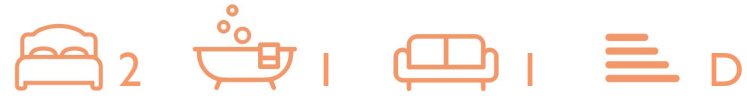

- DUPLEX APARTMENT
- TWO DOUBLE BEDROOMS
- LOUNGE DINER
- RESIDENTS PARKING
- BALCONY
- GENEROUS KITCHEN
- CLOSE TO FAREHAM SHOPS
- IDEAL FIRST TIME BUY

KITCHEN

9'2" x 12'5" (2.8 x 3.8)

LOUNGE/DINER

16'0" x 12'1" (4.9 x 3.7)

SHOWER ROOM

6'6" x 4'11" (2.0 x 1.5)

BEDROOM 1

13'5" x 11'5" (4.1 x 3.5)

BEDROOM 2

9'6" x 14'1" (2.9 x 4.3)

Financial Services

If you are looking to get a comparison on your mortgage deal then do let us know as we can put you in touch with some independent mortgage advisors that would be happy to help. It is always worth

a last minute comparison before you purchase a property as the current deals can change weekly.

Solicitors

If you are looking for a solicitor to handle the conveyancing process then do let us know as we can point you in the direction of some local, well recommended companies that would be happy to help and provide you with a quote.

Anti Money Laundering

Castles Estate Agents have a legal obligation to complete anti-money laundering checks at our cost via a portal called Credas. Please note the Credas AML check includes taking a copy of identification for each purchaser, a proof

of address and proof of name document is required. Please note we cannot agree a transaction without the Credas AML check being completed and there will be a small admin fee of £25+VAT charged to the successful purchasers to complete these legally required checks.

Lease Information

Lease Length: 84 Years Remaining

Service Charge & Ground Rent: £80 PCM (£960 Per Annum)

* Please be aware this information has been provided to us by the sellers to the best of their knowledge and will be clarified specifically by the solicitors during the conveyancing process *

